

RYANA



Every Step In Steel

Relationship Built On Trust

An Indian Group With Global Outlook

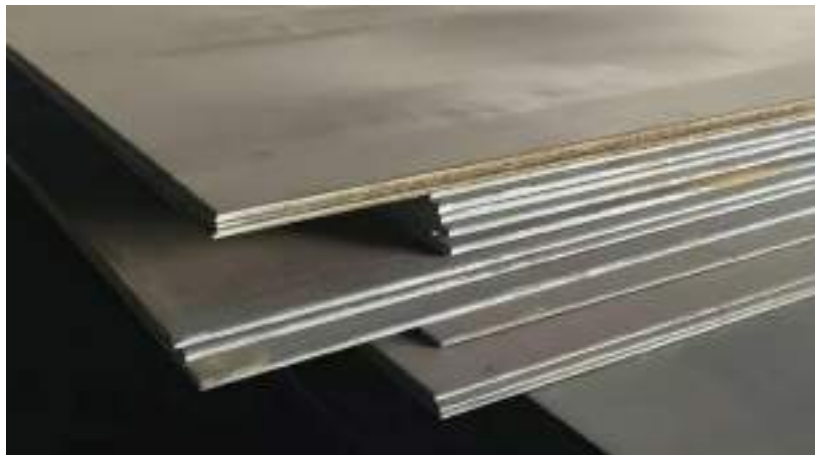

www.steelplatems.com



SINCERITY LASTS LONG.

**GOOD REPUTATION IS
ALWAYS CHERISHED**



STAND HIGH AIM FAR



**BIG ENVIRONMENT
MAKES BIG DEVELOPMENT
BIG SPACE
MAKES BIG ACHIEVEMENT**



RYAN

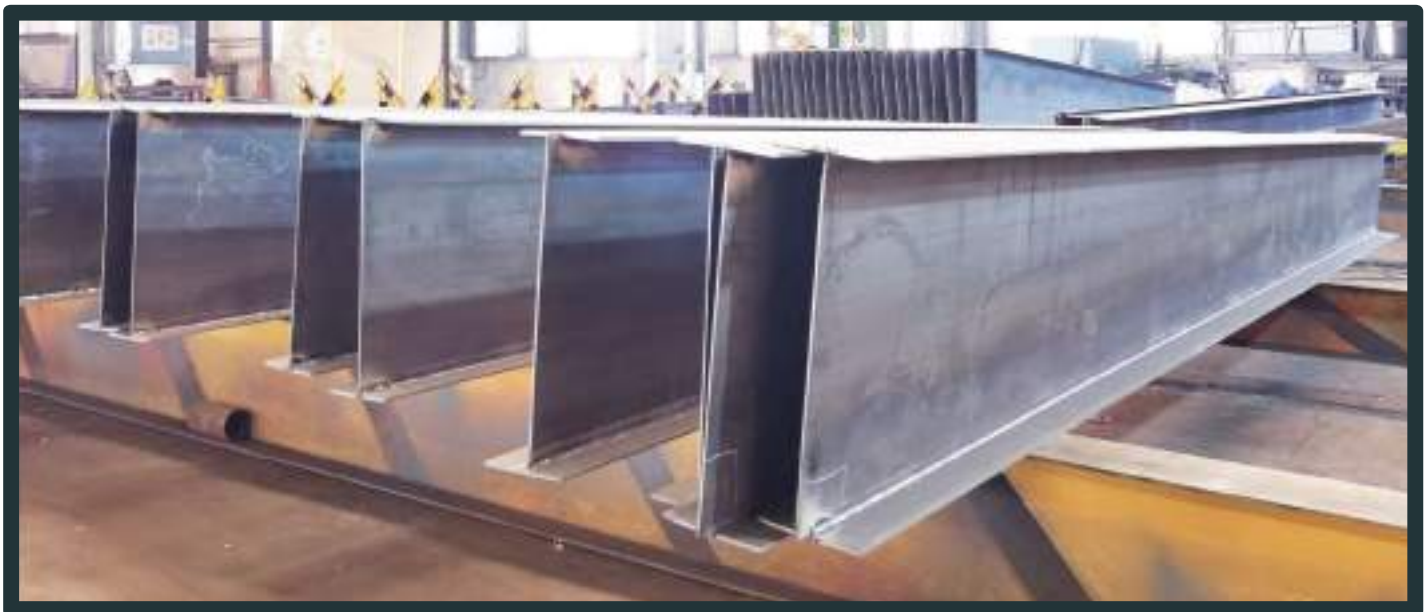



SPIRAL PIPES/ LSAW PIPES/ SAW PIPES

- We provide pipes as per IS 3589- Fe 410 grades/ API Grades
- Coating 3LPE/ Food grain Epoxy etc.
- Fabrication of pipe sizes up to 4 Mtr diameter at site along with hydro and other required testing.

HR Coil / GP COILS PPGI Coils / CRCA Coils / SS Coils / Sheets

- HR Coils/ Sheets/ Plates as per IS 2062, E-250/350, ST-52, E34 etc.
- SS Sheets of grades 202,304 etc.
- PPGI Coils/sheets as per IS 14246
- GP Coils As per IS 277
- CRCA Coils as per IS 513 – "D", "DD"/ "EDD" Grades.

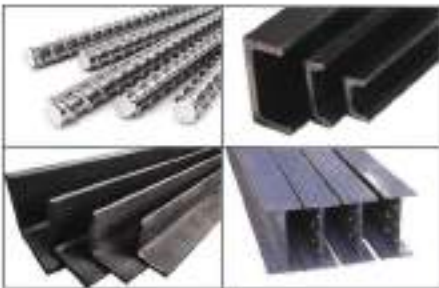
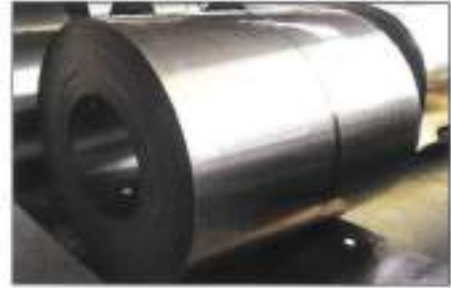

We also supply TMT Bars,
Angles, Channels and Beams as
per IS Grades

ERW Pipes

- We supply ERW Pipes fro ½" to 20"
- We also provide Square and rectangle ERW Pipes from 20 X 20 to 250 X 250





HOT AND COLD ROLLED COILS

Sr. No	Description	Thickness Range	Width Range	Coil Weight in Tons	Indian Grade	Equivalent Grade
1	Prime Hot Rolled Steel Coil	1.60 mm To 20 mm	1250 mm To 2000 mm	5 -27	IS 2062 E-250 / 350	A 36 / ST 37 -2 / ST 52 - 2
2	Prime Cold Rolled Full Hard Steel Coil	0.16 mm To 0.40 mm	900 mm To 1250 mm	5 -10	IS -513 - FH	JIS 3141 Spec-1B, Oiled
3	Prime Cold Rolled CRCA Steel Coil	0.40 mm To 2.00 mm.	1000 mm To 1600 mm	5 -10	IS -513 - D	JIS 3141 Spec-SD, Annealed/, Skin pass & Oiled
4	Prime Cold Rolled CRCA Steel Sheet	0.30 mm To 3 mm	900 mm To 1600 mm	2500 mm To 6000 mm	IS -513 - D	JIS 3141 Spec-SD, Annealed/, Skin pass & Oiled
5	Pre-Painted Galvanized Steel Coil	0.28 mm to 1.00 mm	1220 mm to 1250 mm	3 - 7	IS - 14246	EN-10346
6	Galvanized Steel Coil / sheet	0.14 mm to 2.0 mm	900 mm to 1500 mm	5 -10	IS -277 Hard/ Soft	EN10147 S250 GD, EN- 10346 Dx 51D-2009

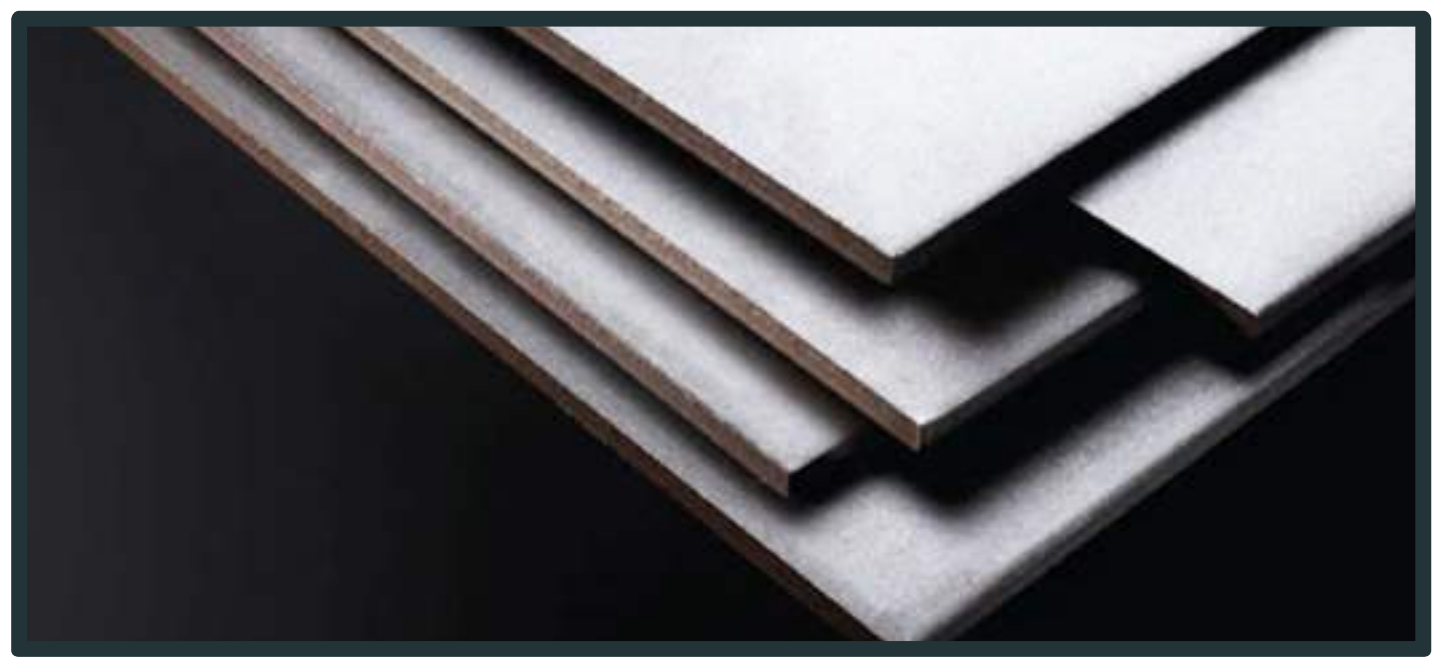
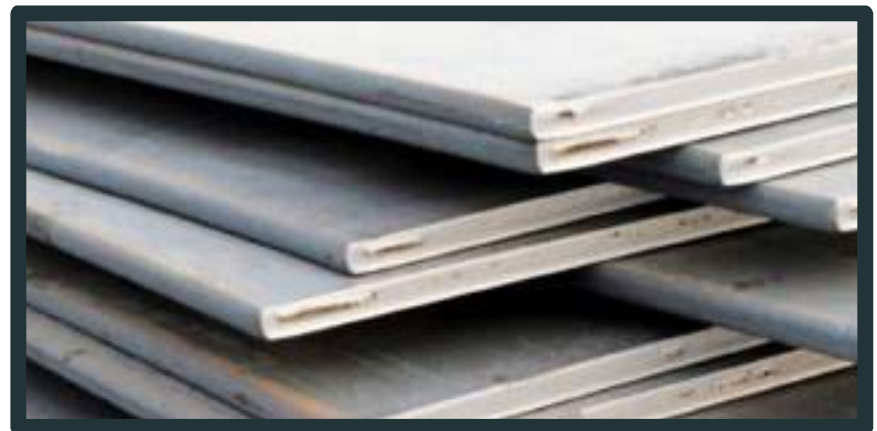

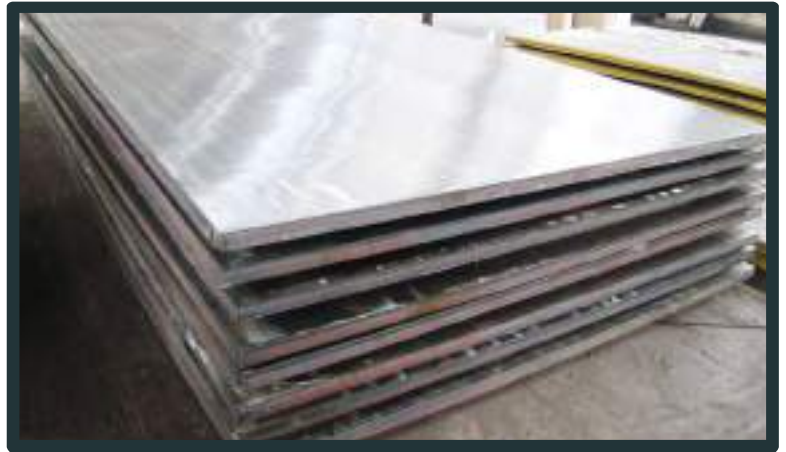

PRODUCT LIST - STEEL PLATES

Sr. No.	Description	Thickness Range	Width Range	Length Range	Indian Grade	Equivalent European Grade
1	MS / HRC Steel Plate	2 mm To 20 mm	1250 mm To 2000 mm	2500 mm To 12000 mm	IS 2062 E-250/350	A36 / ST 37 -2 / ST 52 - 2
Heavy Structural MS Steel Plate						
2	Heavy Structural MS Steel Plate	25 mm To 200 mm	2000 mm To 3000 mm	6000 mm To 12000 mm	IS 2062 E-250/350	A36 ST 37 -2 ST 52 - 2
3	Chequered Steel Plate	2mm To 12 mm	1250 mm To 1500 mm	3000 mm To 12000 mm	IS 2062 E-250/350	A36 ST 37 -2 ST 52 - 2

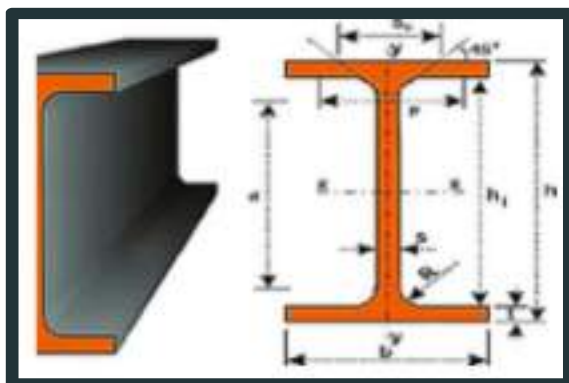

PRODUCT LIST - UPN / IPE STEEL CHANNELS

Sr.No.	Description	Sizes in mm	Length in Mtr	Indian Grade	Equivalent Grade
1	UPN CHANNEL	65 x 42 x 5.5	6 / 12	IS 2062 E-250	ST 37.3 / EN10025
2	UPN CHANNEL	80 x 43 x 5.0	6 / 12	IS 2062 E-250	ST 37.3 / EN10025
3	UPN CHANNEL	100 x 48 x 5.3	6 / 12	IS 2062 E-250	ST 37.3 / EN10025
4	UPN CHANNEL	120 x 53 x 5.5	6 / 12	IS 2062 E-250	ST 37.3 / EN10025
5	UPN CHANNEL	140 x 60 x 8.0	6 / 12	IS 2062 E-250	ST 37.3 / EN10025
6	UPN CHANNEL	160 x 65 x 8.5	6 / 12	IS 2062 E-250	ST 37.3 / EN10025
7	IPE CHANNEL	240 x 120 x 6.2	6 / 12	IS 2062 E-250	ST 37.3 / EN10025





PRODUCT LIST - PIPES AND TUBES

Sr. No.	Description	Diameter Range	Thickness Range	Length Range	Indian Grade	Equivalent European Grade
ERW Black Pipes						
1	ERW Black Pipes	15.8 mm To 600 mm	1.6 mm To 12 mm	3 Mtr To 12 Mtr	IS -1239, IS 3589 - Fe410/API Grades	JIS G3445, ASTM A513, API 5CT, 5L Gr. B
2	Hot Dip Galvanised Pipes	15.8 mm To 200 mm	1.60 To 6 mm	3 Mtr To 12 Mtr	IS -1239, IS 3589 - Fe410 Grades	JIS G3445, ASTM A513, API 5CT, 5L Gr. B
3	SS Tubes & Pipes	6 mm to 168 mm Tube. Above 168 mm up to 600 mm Pipes.	0.60 to 6 mm	3 mtr To 6 Mtr	SS 202, 304, 316 L	ASTM A249, 269, A312, A213, ASTM -A358
ERW Section Sizes						
1	Square and Rectangle	20 x 20 mm To 250 x 250 mm	1.6 mm To 12 mm	3 Mtr To 12 Mtr	IS -1239, IS 3589 IS 4923 Fe410	EN-10219/ JISG3466
CRCA Tubes						
1	CRCA Tubes	OD 8 mm To 100 mm	0.40 mm To 2.50 mm	3 Mtr To 12 Mtr	IS - 3074, IS 3601	EN- 10219/JIS G3466



PRODUCT LIST - PIPES AND TUBES

Spiral Pipes						
1	Spiral Pipes	OD 600 mm To 2500 mm	6 mm To 20 mm	6 Mtr To 12 Mtr	IS -3589, Fe410, E300, 350. API GRADE (Oil & gas)	ASTM- A653

PRODUCT LIST - MS STEEL PIPES / TUBES

Sr.No.	Description	Sizes in mm	Length in Mtr	Indian Grade
1	TUBES	20 x 20 x 1.5	6 / 9 / 12	IS 2062 E-250
2	TUBES	35 x 35 x 3	6 / 9 / 12	IS 2062 E-250
3	TUBES	40 x 40 x 3	6 / 9 / 12	IS 2062 E-250
4	TUBES	60 x 30 x 1.75	6 / 9 / 12	IS 2062 E-250
5	TUBES	80 x 40 x 2	6 / 9 / 12	IS 2062 E-250
6	TUBES	100 x 50 x 3	6 / 9 / 12	IS 2062 E-250
1	PIPES	Ø6" x 5	6 / 9 / 12	IS 2062 E-250
2	PIPES	Ø25 x 2.5	6 / 9 / 12	IS 2062 E-250
3	PIPES	Ø1.25" x 1.5	6 / 9 / 12	IS 2062 E-250
4	PIPES	Ø50 x 3.5	6 / 9 / 12	IS 2062 E-250
5	PIPES	Ø110 x 5	6 / 9 / 12	IS 2062 E-250



PRODUCT LIST - ROUND BAR

Sr.No.	Description	Sizes in mm	Length in Mtr	Indian Grade
1	ROUND BAR	Ø 6	6 / 9 / 12	IS 2062 E-250
2	ROUND BAR	Ø 12	6 / 9 / 12	IS 2062 E-250
3	ROUND BAR	Ø 16	6 / 9 / 12	IS 2062 E-250
4	ROUND BAR	Ø 18	6 / 9 / 12	IS 2062 E-250
5	ROUND BAR	Ø 25	6 / 9 / 12	IS 2062 E-250
6	ROUND BAR	Ø 30	6 / 9 / 12	IS 2062 E-250
7	ROUND BAR	Ø 35	6 / 9 / 12	IS 2062 E-250
8	ROUND BAR	Ø 38	6 / 9 / 12	IS 2062 E-250
9	ROUND BAR	Ø 80	6 / 9 / 12	IS 2062 E-250
10	ROUND BAR	Ø 100	6 / 9 / 12	IS 2062 E-250

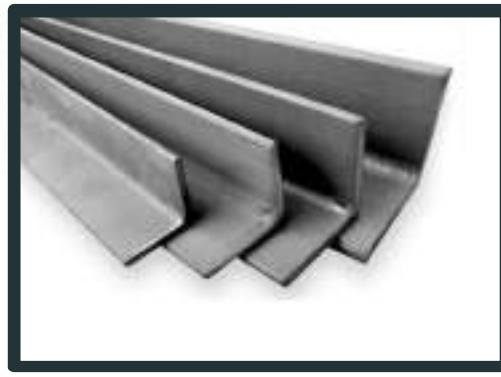

PRODUCT LIST - MS ANGLES

Size in mm	Weight in Kgs. Per	Weight in Kgs. Per
20 X 20 X 3	0.27	0.89
25 X 25 X 3	0.33	1.09
25 X 25 X 5	0.54	1.79
31 X 31 X 3	0.39	1.28
35 X 35 X 5	0.79	2.59
37 X 37 X 3	0.51	1.70
40 X 40 X 3	0.54	1.79
40 X 40 X 5	0.91	3.00
40 X 40 X 6	1.06	3.49
50 X 50 X 5	1.15	3.79
50 X 50 X 6	1.37	4.50
60 X 60 X 6	1.64	5.39
65 X 65 X 6	1.76	5.79
65 X 65 X 8	2.34	7.69
65 X 65 X 10	2.86	9.39
75 X 75 X 6	2.07	6.79
75 X 75 X 8	2.71	8.89
75 X 75 X 10	3.35	10.99
80 X 80 X 6	2.22	7.29
80 X 80 X 8	2.92	9.59
90 X 90 X 6	2.49	8.19
90 X 90 X 8	3.29	10.80

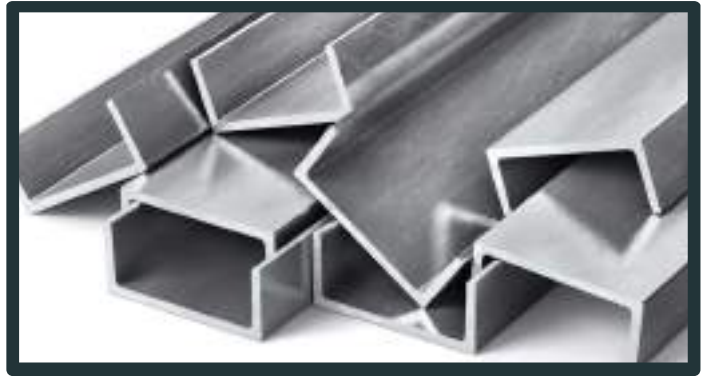

PRODUCT LIST - MS ANGLES

Size in mm	Weight in Kgs. Per	Weight in Kgs. Per
90 X 90 X 10	4.09	13.40
100 X 100 X 6	2.80	9.20
100 X 100 X 8	3.68	12.09

PRODUCT LIST - MS CHANNELS

Size in mm	Weight in Kgs. Per	Weight in Kgs. Per Mtr.
75 X 40	2.17	7.12
100 X 50	2.92	9.59
125 X 65	3.99	13.09
150 X 75	5.12	16.79
175 X 75	5.97	19.59
200 X 75	6.79	22.29
250 X 80	9.32	30.59
300 X 90	11.06	36.29
400 X 100	15.27	50.30



PRODUCT LIST - MS TMT BAR

Size in mm	Weight in Kgs. Per	Weight in Kgs. Per
6	0.0	0.220
8	0.1	0.395
10	0.1	0.617
12	0.2	0.885
16	0.4	1.578
20	0.7	2.466
25	1.1	3.852
32	1.92	6.313

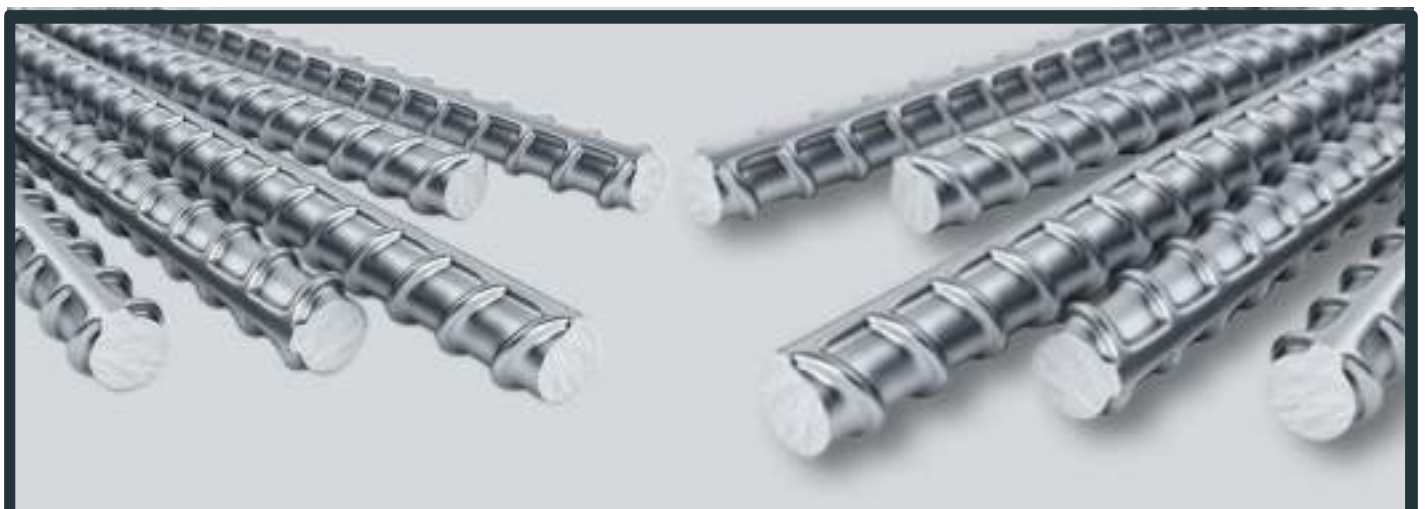



Equal Angle Steel Sizes Length (6 to 12 Mtr)

Size (mm)	Thickness (mm)	Weight (kg/m)	Size (mm)	Thickness (mm)	Weight (kg/m)
20	3	0.889	75	10	11.089
20	4	1.145	75	9	10.06
25	2	0.753	80	5	6.211
25	4	1.459	80	6	7.376
30	2	0.922	80	7	8.0525
30	3	1.373	80	8	9.685
30	4	1.786	80	10	11.874
40	3	1.852	90	6	8.35
40	4	2.422	90	7	9.656
40	5	2.976	90	10	13.476
45	4	2.736	90	12	15.94
45	5	3.369	100	6	9.366
50	3	2.332	100	7	10.83
50	4	3.059	100	8	12.276
50	5	3.77	100	10	15.12
56	6	4.465	100	12	17.898
56	4	3.446	100	16	23.257
60	5	4.251	110	7	11.928
60	5	4.52	110	8	13.532
63	6	5.42	110	10	16.69
63	4	3.907	110	12	19.782
63	5	4.822	110	14	22.809
63	8	7.469	120	8	14.88
63	10	9.151	120	10	18.37
65	5	5	120	12	21.666
65	6	5.91	120	10	18.37
65	8	7.66	120	12	21.66
70	5	5.397	125	8	15.504
70	6	6.406	125	10	19.133
70	8	373	125	14	26.193
75	5	5.818	130	10	19.8
76	6	6.905	130	12	23.6
75	8	9.03	130	14	27.2

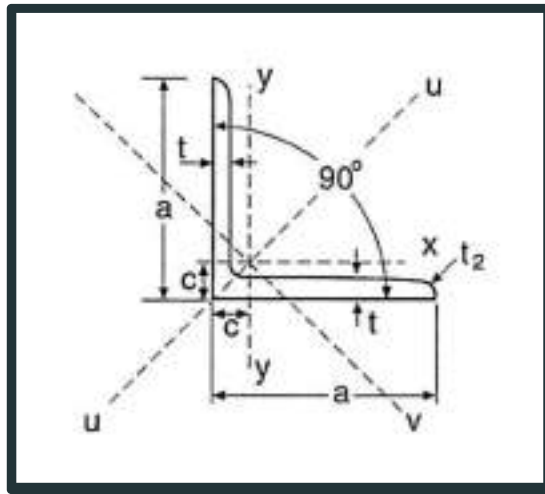

Equal Angle Steel Sizes Length (6 to 12 Mtr)

Size (mm)	Thickness (mm)	Weight (kg/m)	Size (mm)	Thickness (mm)	Weight (kg/m)
130	16	30.9	200	15	45.3
140	10	21.488	200	16	48.68
140	12	25.522	200	18	54.401
140	14	29.49	200	20	60.056
140	16	33.393	200	24	71.168
150	9	20.7	200	25	73.6
150	10	23	220	16	53.901
150	12	27.3	220	18	60.25
150	14	31.6	220	20	66.533
150	15	33.8	220	22	72.751
160	10	24.729	220	24	78.902
160	12	29.391	220	26	84.987
160	14	33.987	250	18	68.956
160	16	38.581	250	20	76.18
175	12	31.8	250	24	90.433
175	15	39.4	250	25	93.77
180	12	33.159	250	26	97.461
180	14	38.382	250	28	104.422
180	18	48.634	250	30	111.318
200	14	42.894	250	32	118.149



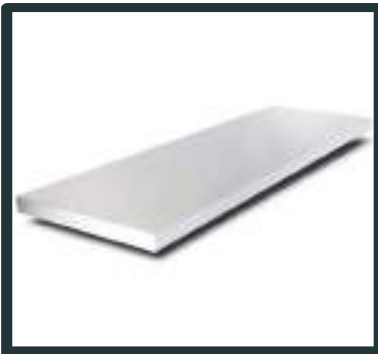

FLAT BAR			
Width (mm)	Thickness (mm)	Length (m)	Theoretical Weight (kg/m)
20	2.0	6/9/12	0.31
20	2.5	6/9/12	0.39
20	2.75	6/9/12	0.43
25	2.5	6/9/12	0.49
25	3.75	6/9/12	0.74
30	2.5	6/9/12	0.59
30	3.5	6/9/12	0.82
30	9.75	6/9/12	2.30
40	3.5	6/9/12	1.10
40	4.75	6/9/12	1.50
40	11.75	6/9/12	3.96
50	2.75	6/9/12	1.08
50	4.5	6/9/12	1.77
50	9.75	6/9/12	3.83
60	5.5	6/9/12	2.60
60	7.5	6/9/12	3.53
60	11.5	6/9/12	5.42
80	5.5	6/9/12	3.45
80	7.5	6/9/12	4.71
80	11.75	6/9/12	7.38
100	3.25	6/9/12	2.55
100	4.75	6/9/12	3.73
100	7.5	6/9/12	5.89
120	9.75	6/9/12	9.18
120	11.75	6/9/12	11.07
150	9.75	6/9/12	11.48
150	11.5	6/9/12	13.54
150	13.5	6/9/12	15.90
160	11.75	6/9/12	14.76
200	9.5	6/9/12	14.92
250	5.75	6/9/12	11.28
340	7.75	6/9/12	20.68



EVERY STEP IN STEEL

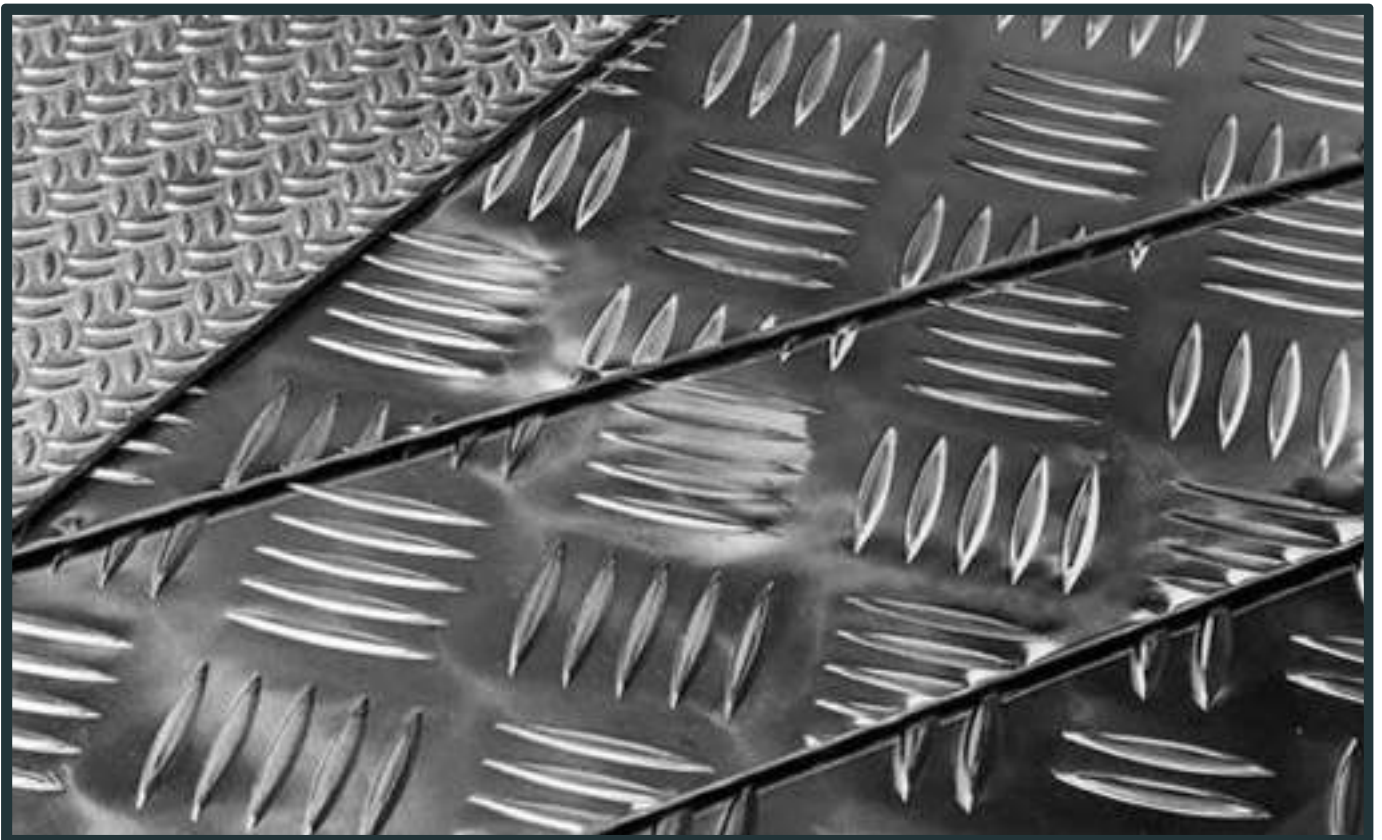



Export Office: Ryan International.

2nd Floor, Office No 12A, K K Chambers, Purushottamdas Thakurdas Road, Near Siddharth College, Fort, Mumbai - 400001. India.

Tel: + 91 22 22016016 , +91 22 22016024

Mob: + 91 9819664898 / 9820456819

Email: globe@mssteelplate.com

ryaninternational100@gmail.com

URL: www.steelplatems.com

